

METRISCHE TEILUNG

À PAS MÉTRIQUE METRIC PITCH

feinstgestossen
taillage de précision
precision cut

Quality
7h25

Teilung / pas / pitch (mm)

2 5 7.5 10 12.5

Gerade verzahnt, feinstgestossen

Dentures droite, taillage de précision

Straight tooth, precision cut

Material: ETG88 DIN 17210 für RDMZ
Ck45 K+N DIN 1.1191 für DMZ

Profil: allseitig geschliffen

Zahnung: Eingriffswinkel $\alpha=20^\circ$
feinstgestossen

Qualität: 7h25 DIN 3962/63/67

Matière: ETG88 DIN 17210 pour RDMZ
Ck45 K+N DIN 1.1191 pour DMZ

Profil: rectifiée toutes les faces

Denture: angle de pression $\alpha=20^\circ$
taillage de précision

Qualité: 7h25 DIN 3962/63/67

Material: ETG88 DIN 17210 for RDMZ
Ck45 K+N DIN 1.1191 for DMZ

Profil: all faces ground

Teeth: pressure angle $\alpha=20^\circ$
precision cut

Quality: 7h25 DIN 3962/63/67

F_p (mm):

Teilungs-Gesamtabweichung

Erreur totale de pas

Cumulative pitch error

P_f (mm):

Toleranz der teilungsgenauen Ablängung

Tolérance de coupe par rapport au pas

Tolerance of cut for continuous mounting

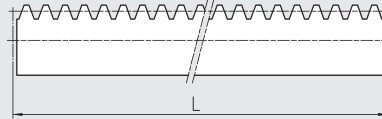
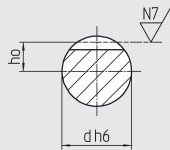
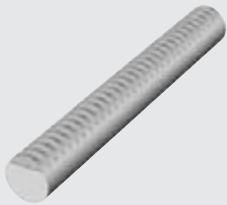

Type	Part No.	L	Module	P	h ₀	d _{h6}	F _p	P _f	m (kg)
RDMZ 2.0	151 020	1 000	0.637	2.0	4.36	10	0.078	-0.05/0.21	0.62
RDMZ 5.0	151 050	1 000	1.592	5.0	5.91	15	0.057	-0.05/0.52	1.39
RDMZ 7.5	151 075	1 005	2.387	7.5	7.61	20	0.052	-0.05/-0.78	2.48
RDMZ 10.0	151 100	1 000	3.183	10.0	11.82	30	0.050	-0.05/-1.05	5.55
RDMZ 12.5	151 125	1 000	3.979	12.5	16.02	40	0.051	-0.05/-1.31	9.86

p (mm) Teilung, pas, pitch

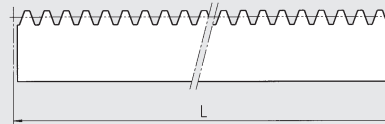
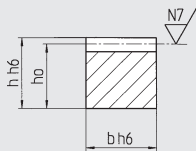
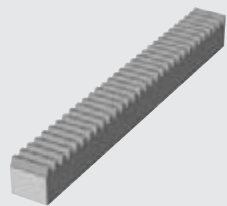

Type	Part No.	L	Module	p	h ₀	b	h	p _f	m (kg)
DMZ 2.0	152 020	1 000	0.637	2.0	8.86	9.5	9.5	-0.05/-0.21	0.66
DMZ 5.0	152 050	1 000	1.592	5.0	12.90	14.5	14.5	-0.05/-0.52	1.47
DMZ 7.5	152 075	1 005	2.387	7.5	17.11	19.5	19.5	-0.05/-0.78	2.63
DMZ 10.0	152 100	1 000	3.183	10.0	26.32	29.5	29.5	-0.05/-1.05	6.09
DMZ 12.5	152 125	1 000	3.979	12.5	35.52	39.5	39.5	-0.05/-1.31	11.01

p (mm) Teilung, pas, pitch

