



Stainless steel

Advantages

- corrosion resistant
- transmission of high torque values
- reduced contact surface pressure
- external compression design
- good cyclic running features

Please consider the following tolerances:

d w (mm)		ISO	max clearance S mm
from	to		
18	30	H 6 / j 6	0,017
30	50	H 6 / h 6	0,032
50	80	H 6 / g 6	0,048

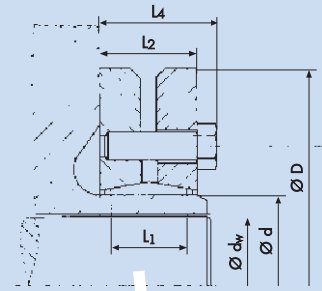

Technical Data and Dimensions

Shaft sizes up to 80 mm
Torque up to 3.190 Nm

Stainless steel

Shrink Disc Dimensions						Transmissible Torque	Axial Force	Surface contact pressure	Number of screws	Type of screws	Tightening torque of screws
Ø d mm	Ø d _w mm	Ø D mm	L ₁ mm	L ₂ mm	L ₄ mm	T Nm	F _{ax} kN	P _N N/mm ²	#	G DIN 931	T _A Nm
24	19	50	14	20	23	140	18	214	6	M5	3
	180					18					
	210					21					
30	21	60	16	22	25	210	21	175	7	M5	3
	240					23					
	260					24					
36	28	72	18	24	28	280	28	176	5	M6	7
	340					32					
	360					31					
44	32	80	20	26	30	340	26	182	7	M6	7
	480					38					
	520					41					
50	35	90	22	28	32	630	47	180	9	M6	7
	480					38					
	730					52					
55	36	100	23	31	35	840	57	145	8	M6	7
	590					40					
	740					46					
62	42	110	23	31	35	900	53	190	12	M6	7
	1150					69					
	1280					74					
68	48	115	23	31	35	900	50	146	10	M6	7
	1050					54					
	1460					66					
75	55	138	25	33	38	990	50	139	7	M8	15
	1300					61					
	1700					73					
80	60	145	25	33	38	1140	53	131	7	M8	15
	1500					64					
	1900					75					
90	65	155	30	39	45	1750	74	138	10	M8	15
	2200					87					
	2670					115					
100	70	170	34	44	50	2160	85	133	12	M8	15
	2590					98					
	3190					112					

Additional diameters available upon request. Technical Specifications subject to change without notice.

Order data:

24 x 50 PSV 5003-R
d x D Type

Applications

- waste disposal equipment
- gearboxes
- conveyors
- similar applications connecting shafts with hollow shafts

Technical Details

- tolerances Ø d h8
- surface roughness R_a max 16µm for shaft/hub