

54B Cermet M Bushing

Please select parts no. referring to the internal diameter, the outside diameter and the length to apply.

Ex. Internal diameter 12mm, Outside diameter 18mm, Length 10mm

54B-121810

Please indicate by parts no.

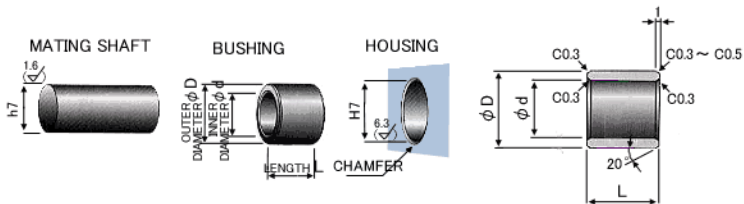

I.D.	O.D.	I ^{-0.1} _{-0.3}										I.D. After Press-Fitting				
		3	4	5	6	8	10	15	20	25	30		40			
3	+0.024 +0.014	6	+0.027 +0.015	030603	030605											+0.017 +0.007
4	+0.032 +0.020	7	+0.034 +0.019	040704	040705	040706										+0.023 +0.011
5	"	8	"		050805	050806	050808									"
6	"	10	"		061005	061006	061008	061010								"
8	+0.040 +0.025	12	+0.041 +0.023			081206	081208	081210	081215							+0.029 +0.014
10	"	16	"			101606	101608	101610	101615	101620						"
12	+0.050 +0.032	18	"				121808	121810	121815	121820						+0.039 +0.021
14	"	20	+0.049 +0.028					142010	142015	142020						+0.036 +0.018
15	"	21	"					152110	152115	152120	152125					"
16	"	22	"					162210	162215	162220	162225					"
18	"	24	"					182410	182415	182420	182425	182430				"
20	+0.061 +0.040	28	"					202815	202820		202830					+0.047 +0.026
25	"	35	+0.059 +0.034							253520	253525	253530				+0.044 +0.023
30	"	40	"							304020	304025	304030	304040			"

54F Cermet M Flange Bushing

Please select parts no. referring to the internal diameter and the length to apply.

Ex. Internal diameter 12mm, length 12mm

54F-1212

Please indicate by **parts no.**

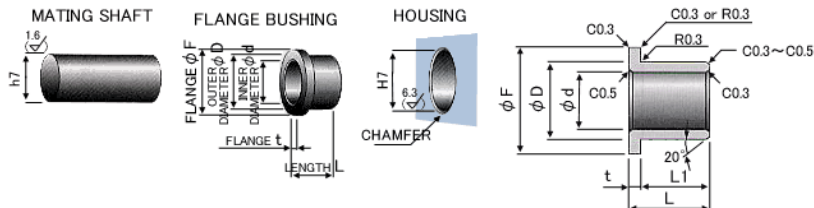

Parts No.	I.D.		O.D.		Flange		Length		I.D. After Press-Fitting	
	ϕd	ϕD	ϕF	t	L	L1				
54F-0303	3	+0.024 +0.014	6	+0.027 +0.015	9	1.5	4.5	0 -0.4	3	+0.017 +0.007
54F-0404	4	+0.032 +0.020	7	+0.034 +0.019	10	"	5.5	"	4	+0.023 +0.011
54F-0505	5	"	8	"	11	"	6.5	"	5	"
54F-0606	6	"	10	"	14	2	8	"	6	"
54F-0808	8	+0.040 +0.025	12	+0.041 +0.023	16	"	10	"	8	+0.029 +0.014
54F-1010	10	"	16	"	20	"	12	"	10	"
54F-1212	12	+0.050 +0.032	18	"	22	"	14	"	12	+0.039 +0.021
54F-1414	14	"	20	+0.049 +0.028	24	3	17	"	14	+0.036 +0.018
54F-1515	15	"	21	"	27	"	18	"	15	"
54F-1616	16	"	22	"	28	"	19	"	16	"
54F-1817	18	"	24	"	30	"	20	"	17	"
54F-2021	20	+0.061 +0.040	28	"	34	4	25	"	21	+0.047 +0.026
54F-2521	25	"	35	+0.059 +0.034	42	"	"	"	"	+0.044 +0.023
54F-3026	30	"	40	"	48	"	30	"	26	"

54M Cermet M Bar Stock

Please select parts no. referring to the diameter and the length to apply.
Ex. Diameter 21mm, Length 26mm

54M-2126

Please indicate by **parts no.**

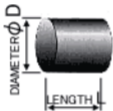

Parts No.	ϕD	L
54M-0910	9	10
54M-1316	13	16
54M-1821	18	21
54M-2126	21	26
54M-2631	26	31
54M-3341	33	41
54M-4146	41	46
54M-6049	60	49